



## **Ruskin® Introduces TED40 Economy Insulated Thinline Control Damper**

**Grandview, MO** – (July 28, 2017) – The TED40 provides low leakage and thermal performance in a thin line 4" deep frame. Blade profile stays within the frame in the full open position which makes it ideal for mounting against louvers or openings.

### CONSTRUCTION

- Extruded aluminum frame and blades
- Foam filled cavities in blade profile
- Molded synthetic axle bearings
- Extruded Ruskiprene blade seals locked into blades
- Flexible stainless steel compression jamb seals
- Concealed linkage mechanically locked in blade

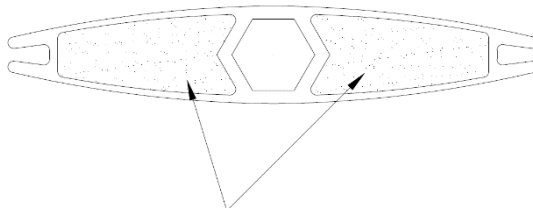

Blade cavities are filled with polyurethane foam for added thermal protection



TED40 Economy Insulated Thinline Control Damper

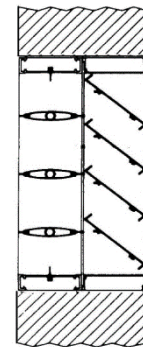

Great for installation behind louvers

### VARIATIONS

- Anodized finishes
- Factory installed actuators and switches
- Front and/or rear flanges
- Stainless steel linkage

For more information about *Ruskin*, visit

<http://www.ruskin.com/model/ted40>

### **For more information:**

Mark Saunders  
 Director of Sales and Marketing,  
*Ruskin*  
 Main: 816-761-7476  
 Direct: 816-986-5467  
 Mobile: 214-587-8165  
[Mark.Saunders@Ruskin.com](mailto:Mark.Saunders@Ruskin.com)